

International Fashion Machines, Inc.
Exclusive Materials, Future Design

Dimensions:
 Wall Plate 2 7/8" x 4 3/4" x 5/16" deep.
 Pom Pom 1 1/2" x 1 1/2" wide x 1" tall
 IFM Catalogue Number 01-001

IFM Catalogue Number 01-001



Installation Instructions
Warnings and Cautions:

Follow all dimmer manufacturer's instructions and warning and cautions as included in dimmer box.
 To be installed and/or used in accordance with appropriate electrical codes and regulations.
 If you are unsure about any part of these instructions, consult an electrician.
 To avoid overheating and possible damage to this device and other equipment, do not install to a control receptacle, fluorescent lighting, a motor- or transformer-operated appliance.
 Total minimum wattage must exceed 40 watts
 Use only one dimmer per load. Do not use 3 way switch.
 Use with incandescent or 120V halogen fixtures only.

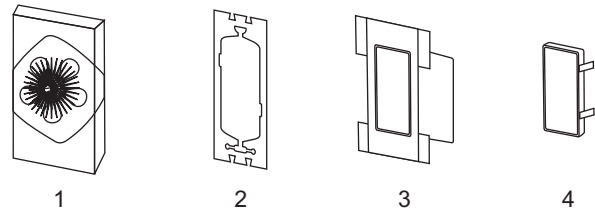

1 IFM Wall Plate 2 Wall Plate Clip 3 Dimmer Unit 4 Color Change Kit

Package Contents (IFM Part Numbers)

- 1) IFM Wall Plate with electronic textile POM POM and embroidered decorative cove.
- 2) Screwless Wall Plate Clip (located on back of wall plate)
- 3) Complete Dimmer Unit, Single-Pole & 3-Way, True Touch, Digital, Preset, Incandescent, 600W, 120 Volt AC 60Hz, LED Locator Light, Soft-ON/Fade-OFF, Radio/TV Filter (with a 2 year warranty) See: <http://www.leviton-lin.com/LC/A44A45.pdf> (Leviton)
- 4) Color-Change Kit (Grey)
- 5) Dimmer Manufacturer's Instructions Located in Dimmer Box
- 6) IFM Instructions (this sheet)

CLEANING: The IFM POM POM is anti-microbial and stain resistant. It requires no cleaning. **Do not sponge or wet IFM POM POM.** The embroidered fabric cover is made with a stain resistant fabric. The embroidered fabric cover can be sponged clean with a damp sponge. Do not submerge any part of the wall plate in water.

INSTALLATION: IFM does not recommend installation in bathroom or kitchen or other damp area. IFM's limited warranty will not cover products installed in those areas.

INTERNATIONAL FASHION MACHINES, INC. , LIMITED WARRANTY STATEMENT; INTERNATIONAL FASHION MACHINES, INC. ("IFM") warrants this product against defects in material or workmanship for the time periods and as set forth below. Under this Limited Warranty, IFM will, at its option, (i) repair the product using new or refurbished parts or (ii) replace the product with a new or refurbished product. For purposes of this Limited Warranty, "refurbished" means a product or part that has been returned to its original specifications. In the event of a defect, these are your exclusive remedies. Term: For a period of ninety (90) days from the original date of purchase of the product, IFM will, at its option, repair or replace with new or refurbished product or parts, any product or parts determined to be defective. Only IFM Product Covered: This Limited Warranty covers only the IFM product. It does not cover technical assistance in using the product. Third-Party Materials Not Covered. This Limited Warranty does not cover any accessories or parts identified as being supplied by a third party. Those third-party accessories or parts may be covered by a separate warranty from their manufacturer. Instructions: To obtain warranty service, you must deliver the product to IFM, postage prepaid, in either its original packaging or packaging affording an equal degree of protection. A dated purchase receipt is required. Repair/Replacement Warranty: This Limited Warranty shall apply to any repair, replacement part or replacement product for the remainder of the original Limited Warranty period or for thirty (30) days, whichever is longer. Any parts or product replaced under this Limited Warranty will become the property of IFM. This Limited Warranty only covers product issues caused by defects in material or workmanship during ordinary consumer use; it does not cover product issues caused by any other reason, including but not limited to product issues due to commercial use, acts of God, misuse, problems with electrical power, limitations of technology, or modification of or to any part of the IFM product. This Limited Warranty does not cover IFM products sold AS IS or WITH ALL FAULTS or consumables (such as fuses or batteries). LIMITATION ON DAMAGES: IFM SHALL NOT BE LIABLE FOR ANY INCIDENTAL OR CONSEQUENTIAL DAMAGES FOR BREACH OF ANY EXPRESS OR IMPLIED WARRANTY OR CONDITION ON THIS PRODUCT. DURATION OF IMPLIED WARRANTIES: EXCEPT TO THE EXTENT PROHIBITED BY APPLICABLE LAW, ANY IMPLIED WARRANTY OR CONDITION OF MERCHANTABILITY OR FITNESS FOR A PARTICULAR PURPOSE ON THIS PRODUCT IS LIMITED IN DURATION TO THE DURATION OF THIS WARRANTY. Some states or jurisdictions do not allow the exclusion or limitation of incidental or consequential damages, or allow limitations on how long an implied warranty lasts, so the above limitations or exclusions may not apply to you. This Limited Warranty gives you specific legal

Installation Instructions

Warning- Follow All Dimmer Manufacturer's Instructions

- Step 1) Review Leviton Dimmer Instructions.** Open manufacturer's dimmer box and review all Leviton instructions before installing dimmer. Always follow these instructions.
- Step 2) Change Dimmer Color to Grey.** Using IFM Part 2 and 4, follow Leviton's dimmer Instructions to change the color of your dimmer. (These instructions are located on the Leviton instruction sheet, side 1, under the list of tools you will need and before Leviton Step 1). Once this step is complete, your Dimmer Unit (IFM Part 3) should have a grey plate (IFM part 4) on the front. Your dimmer will now match your IFM Wall Plate.
- Step 3) Remove Wall Plate Clip** (IFM Part 2) from back of IFM Wall Plate (IFM part number 1).
- Step 4) Turn Off Power** at circuit breaker or fuse.
- Step 5) Install Dimmer.** Follow Leviton Manufacturer's Instructions to install Dimmer Unit into your wall box. Follow through Step 7. Do not attach IFM Wall Plate (IFM Part 1) .
- Step 6) Restore power and test dimmer** without IFM Wall Plate (IFM Part 1) according to OPERATION instructions on Leviton sheet.
- Step 7) Turn Off Power** at circuit breaker or fuse.
- Step 8) Install Wall Plate Clip.** Loosen screws on the dimmer. Attach Wall Plate Clip (IFM part 2) to front of installed Dimmer (IFM part 3). Be sure that the "wall side" of the clip is facing the wall.
- Step 9) Remove Tape Backing from IFM Wall Plate** (IFM Part 1). On the back of the IFM Wall Plate is a piece of tape. Remove tape backing, but not tape. See Drawing A.
- Step 10) Snap IFM Wall Plate onto Wall Plate Clip.** Press down on fabric around POM POM so tape is pressed onto the dimmer.
- Step 11) Restore Power** to dimmer unit.

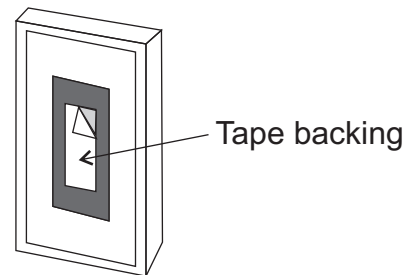
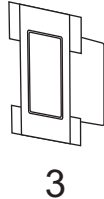
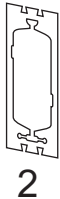

Drawing A

Pom Pom OPERATION

ON: Gently touch the POM POM to fade lights on.

OFF: Gently touch the POM POM to fade lights off.

BRIGHTEN & DIM: Gently squeeze and hold the POM POM to set a preset desired light level. Each time POM POM is touched, the dimmer will toggle between bright and dim.

PRESETS: Dimmer may appear to be not working if the preset is set to very low light level. If this happens squeeze, release, squeeze and hold POM POM to reset brightness level.

AIR GAP SWITCH: The oval hole in the wall plate reveals the dimmer's air gap switch. Follow Leviton instructions for use of air gap wall when servicing light fixture.

CLEANING: The IFM POM POM is anti-microbial and stain resistant. It requires no cleaning. **Do not sponge or wet IFM POM POM.** The embroidered fabric cover is made with stain resistant fabric. The embroidered fabric cover can be sponged clean with a damp sponge. Do not submerge any part of the wall plate in water.



International Fashion Machines, Inc.

Exclusive Materials, Future Design